



IRIS – LOGGING IN WITH DIFFERENT USER ROLES

Contents

Objective:	1
Prerequisite Conditions	1
Checklist	1
SSO Enabled Login As:	2

Objective:

IRIS is our Immigration and Refugee Information System. An email ID is required upon user creation. If a new user is created with an email ID that already exists in IRIS, then the new user will be added to the existing account. This document details how a user can login into IRIS using either of those organizations.

Prerequisite Conditions

- End use has a OneLogin account.
- End User has an email ID associated with 2 or more IRIS accounts, all with a different organization.

Checklist

High level list of the steps required to successfully login with different user roles.

SSO Enabled

- Login to One Login
- Go to 'IRIS – SSO' application.
- Select Organization from dropdown menu and select Go.

SSO Enabled Login As:

- Step 1: Login to OneLogin – <https://lirs.onelogin.com>

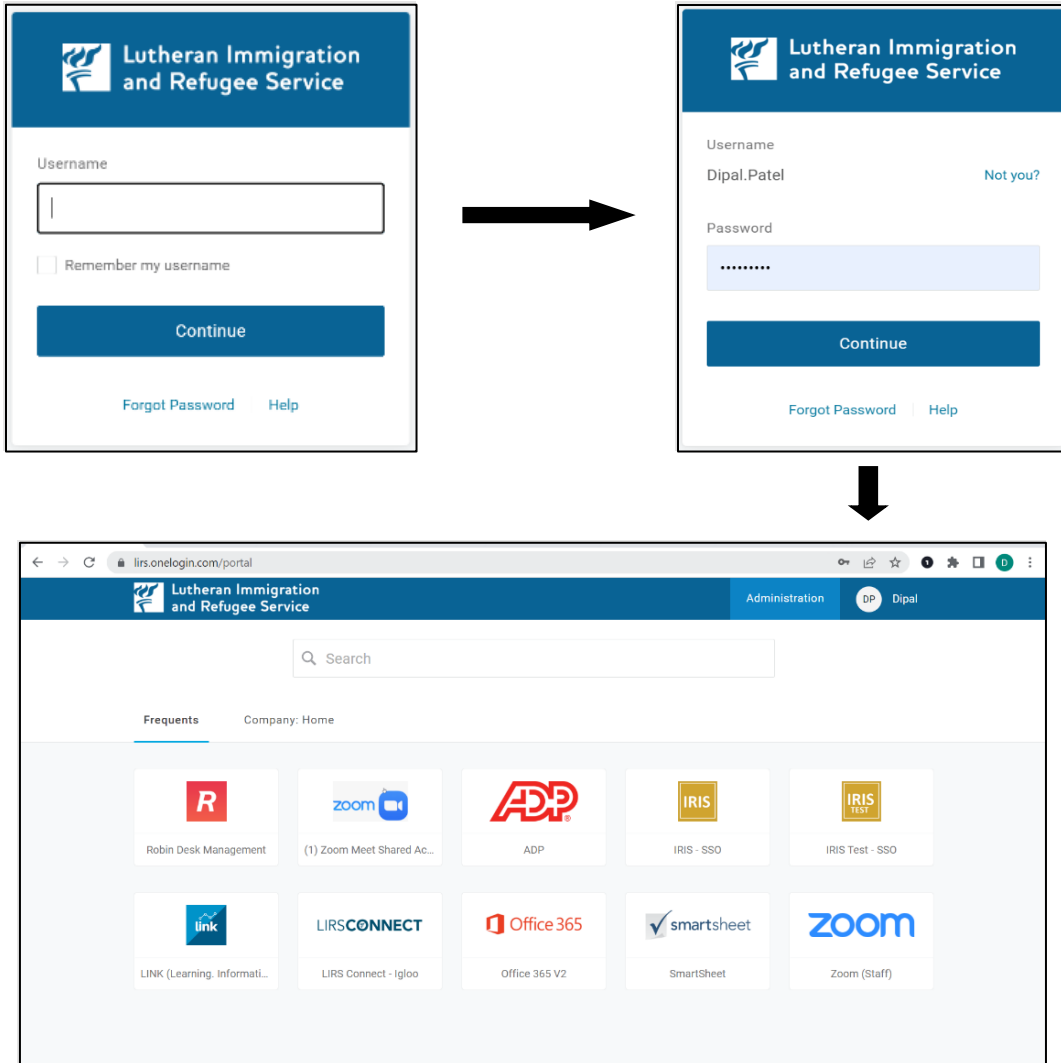

- Step 2: Search for and select the 'IRIS – SSO' widget.
 - User will be redirected in a new tab to the IRIS Login Screen (<https://lirs.irisweb.org/Login/OneLogin/LoginMultiUser.aspx>)

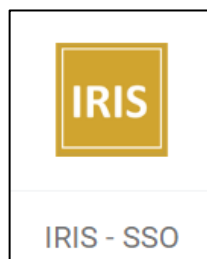

- Step 3: Under 'Select Organization to Login' click the dropdown menu.
 - This will give the user of logging into any organization their account is associated with.

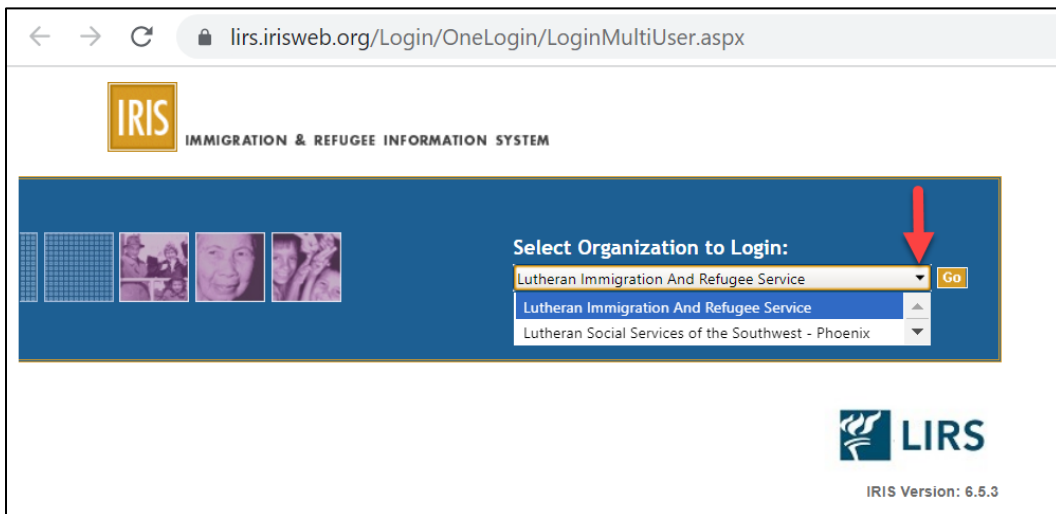
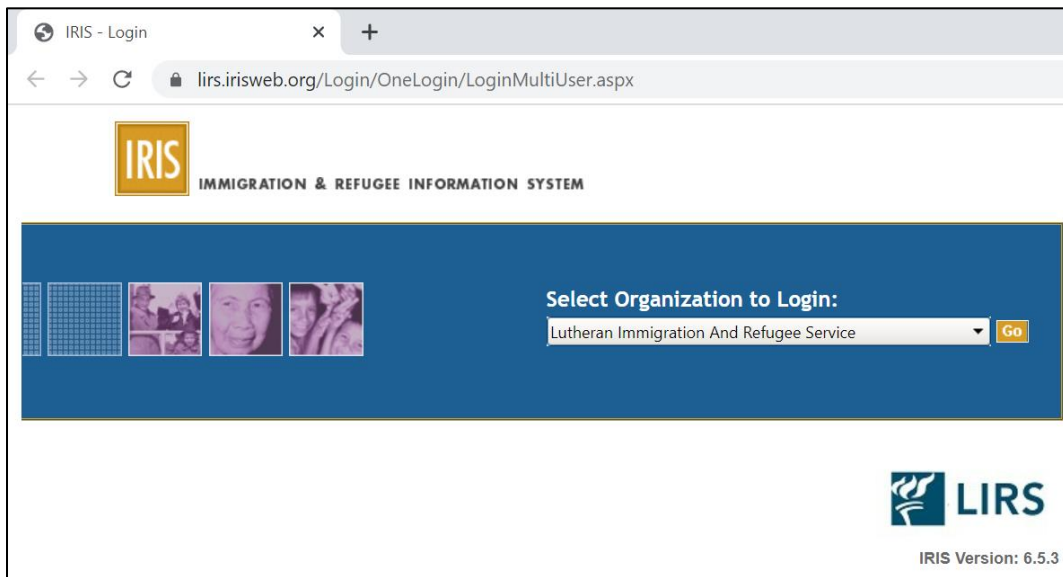

- Step 4: Select an organization from the dropdown menu and select go.
 - User will now be redirected to the IRIS homepage.